

## COB576LEDs-DC24V-8MM

## SPECIFICATION

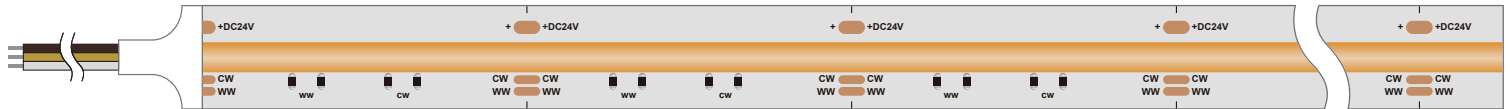

576<sub>m</sub>  
LED Qty

24<sub>v</sub>  
Voltage

8<sub>mm</sub>  
FPC width

20<sub>W/m</sub>  
Power

**Product features:**

- Support special customization and sample customization
- Two-color smart lighting create a warm atmosphere
- Color temperature and brightness can be adjusted freely between 2700K~6000K
- 120° illumination angle, high CRI, no spot, no flicker
- IP20 is not waterproof (can be processed to customize IP65\IP67\IP68 protection level)
- Precise production, quality assurance, 5-year warranty
- High-quality double-sided copper FPC board, flexible and resistant to bending, strong and durable

**Application:**

Widely used in hotels, shoppingmalls, furniture, cabinets, shelf as decoration lighting, direct lighting or indirect lighting

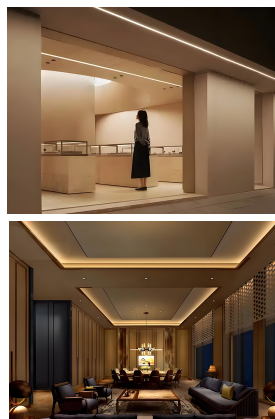

Product parameters:

General parameters

Product Model	GL-R1000TF-576SxCOBADJ COB576leds/meter Dual Color
Color	WW, NW,CW
CCT(K)	2700K~6000K
CRI	Ra≥90
Beam angle	120°
Cut Distance	41.66mm

Environmental test parameters

IP grade	IP20
Working environment	-25℃~+45℃
Storage environment	-30℃~+80℃
Max connection Length	5m

Performance parameters

Lumen(±5%)	1800~2000lm/m
Efficiency(±5%)	90~100lm/W
Voltage	DC24V
Electric current	833mA/m
Power	20W/m

Packaging parameters

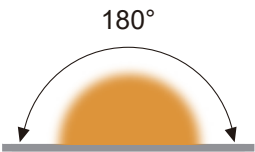
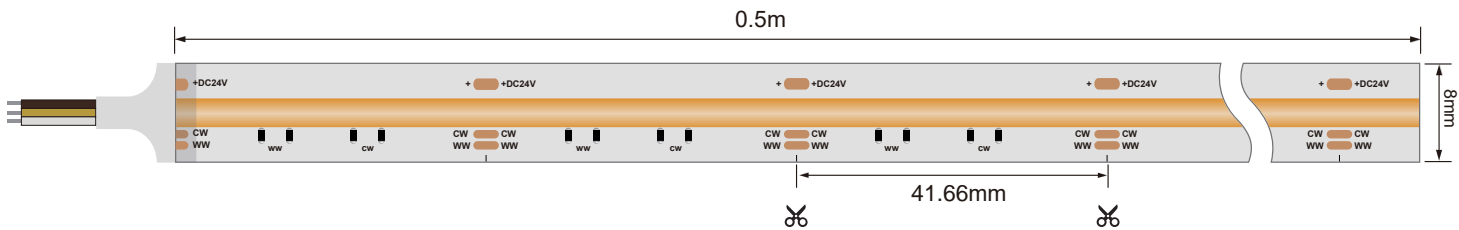

A roll	5m
N.W(Roll)	110g
Qty/Carton	500m-100roll
Packing size(mm)	L420*W420*H180
G.W	12Kg



## Processing custom waterproof process:

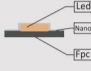
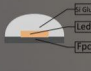
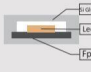
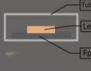

**Contrast of Process**

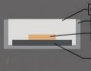
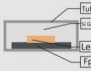
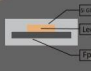
IP RATING	STRUCTURE	FEATURE	REMARK
IP20		Non-Waterproof	Indoor Use Only
IP54		Nano Coated	Thin Film Coating Anti Splash Water Tiny Size Changed (Same Looking as IP20)
IP65		Silicone glue Coated Waterproof Suitable for Damp Location	Silicone Glue Coating Dropping Anti Splash Water Tiny Size Changed
IP67A		Silicone Extrusion Waterproof Suitable for Short-time Wet Location	Extruding Process Suitable for outdoor places without standing water
IP67B		Silicone Tube Waterproof Suitable for Damp Location	Silicone Empty Inside Anti Spray Water Tiny Color Shift
IP67C		Silicone Extrusion Waterproof Suitable for Short-time Wet Location	Extruding Process Suitable for outdoor places without standing water
IP67D		U-Tube Installed Silicone Glue Waterproof Suitable for Short-time Wet Location	Silicone Glue Coating Suitable for outdoor places without standing water
IP68A		Silicone Tube Injected Silicone Glue Waterproof Suitable for Outdoor and Underwater	360° Silicone Filling Use for Outdoor and Underwater
IP68B		Silicone Solid Extrusion Waterproof Suitable for Outdoor and Underwater	360° Silicone Filling Use for Outdoor and Underwater

IP code : Ingress Protection Marking, IEC standard 60529

## Package:

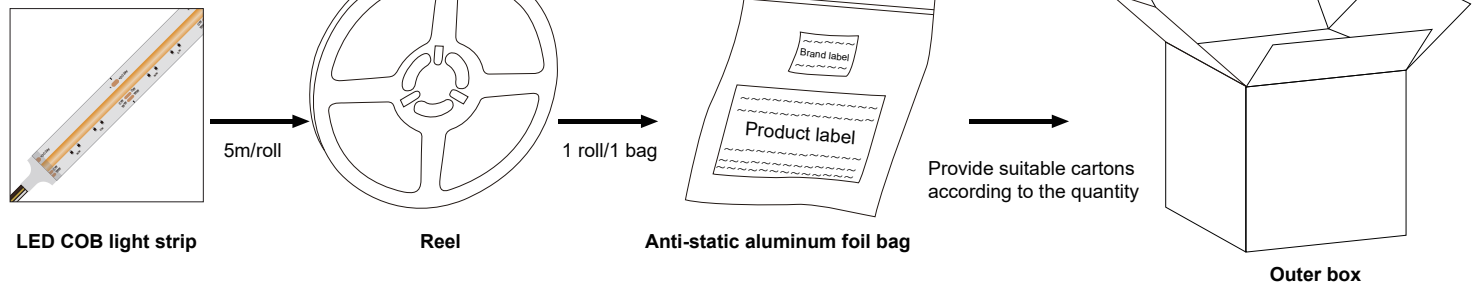

## Installation diagram:

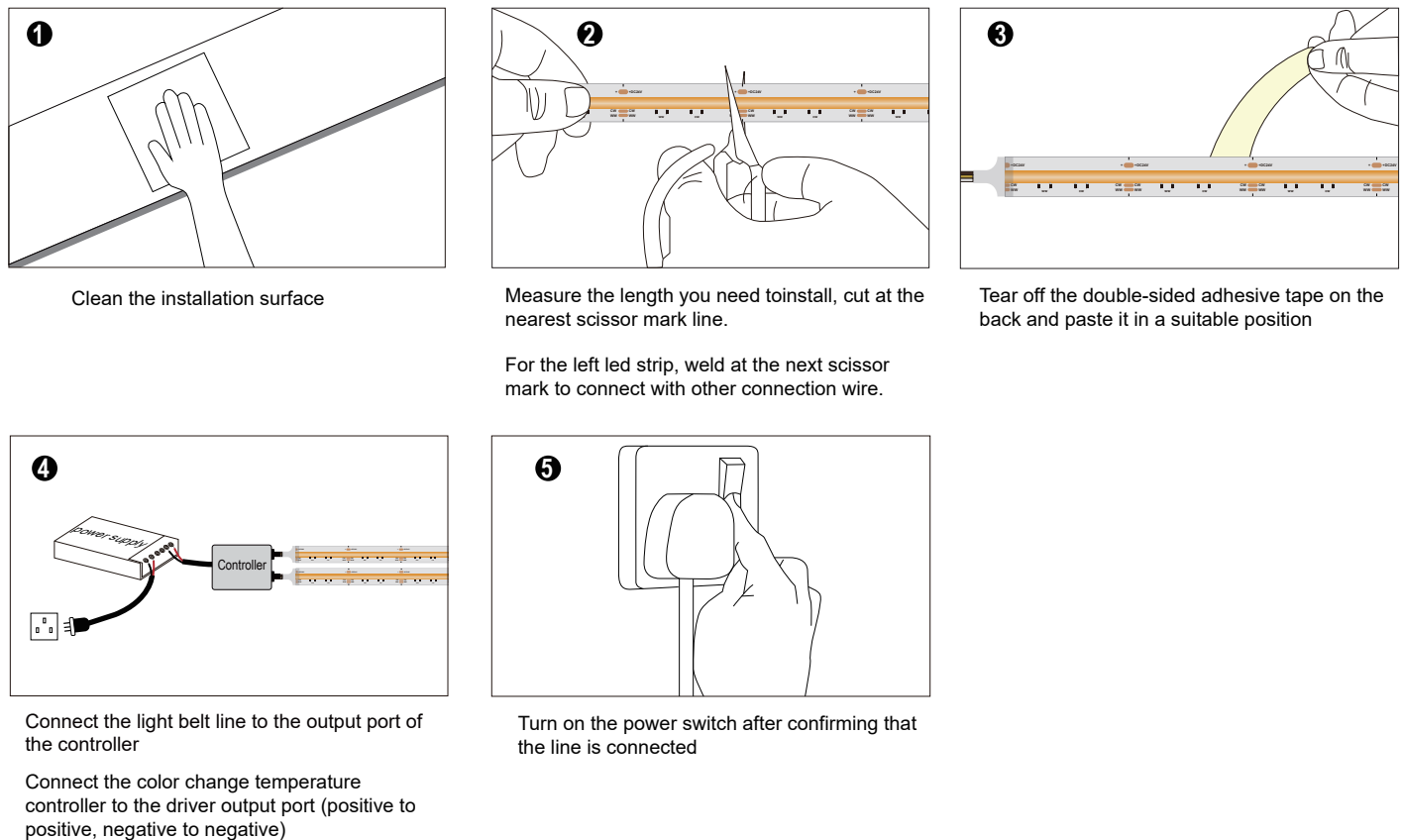

## Statements :

- 1). For safety, the product wire should be moved and replaced by the manufacturer, agent or other authorized person.
- 2). Please refer to the product manual before installation.
- 3). Above-refered schematic diagrams are from our standard product. Please subject to your actual product data if there is difference.
- 4). In actual use, we suggest 80% consumption of the driver. Keep 20% as power to start the led strip.
- 5). For safety, no touch the AC terminal.
- 6). Any acidic or alkaline substance is forbidden.
- 7). No notice for updated of this product.

Problem	Possible reasons	solution
All fail	<ul style="list-style-type: none"> <li>No power supply</li> </ul>	Give power supply.
	<ul style="list-style-type: none"> <li>Automatic switch-off because of the open circuit and short circuit</li> </ul>	Solve the problem, switch on again.
	<ul style="list-style-type: none"> <li>Wrong connection (positive connect with negative)</li> </ul>	Check and get right connection.
Part fail	<ul style="list-style-type: none"> <li>Part power-supply fail</li> </ul>	Check and make sure the power supply well.
	<ul style="list-style-type: none"> <li>Part circuit error</li> </ul>	
	<ul style="list-style-type: none"> <li>Part wrong connection(positive connect negative)</li> </ul>	Check and get right connection.
Inconsistent brightness or insuffiscent brightness	<ul style="list-style-type: none"> <li>overload of the driver</li> </ul>	Use higher-power driver.
	<ul style="list-style-type: none"> <li>Too big power consumption of the switch, or unbalanced power consumption from different strip series.</li> </ul>	Keep the strip working voltage is more or less 5% than the Rated voltage. 1.shorten the connection cable length, or change to thicker cable. 2.Make sure the strip quantity is less than the allowed connection quantity.Keep the led strip quantity of each series similar).
	<ul style="list-style-type: none"> <li>Too many Led strips connection</li> </ul>	Adjust the led strip quantity, make sure sufficient power supply.
LED flash	<ul style="list-style-type: none"> <li>Poor welding connection of wires</li> </ul>	Check,find and solve it.
	<ul style="list-style-type: none"> <li>switch problem</li> </ul>	Change to right switch.