

## COB288/m-AC220V-10MM

## SPECIFICATION

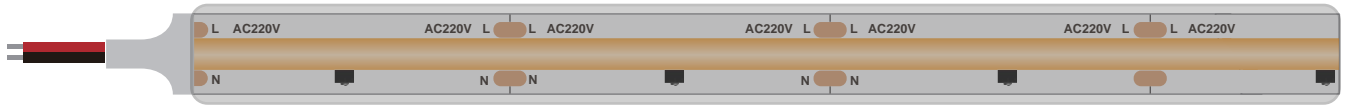

**288** m  
LED Qty

**220** v  
Voltage

**10** mm  
FPC width

**10** W/m  
Power

## Product features:

1. 288 inverted LED chips arranged linearly, integrated packaging, uniform light color, and no light spots.
2. High thermal conductivity flexible circuit board design, can be bent freely, easy to install.
3. The LED chip is directly mounted on the FPCB board, with a light emission angle of up to 180 degrees.
4. AC220V driver free high voltage design, plug in and light up, no need for transformer power supply, low voltage drop, standard length 50 meters.
5. Back mounted high viscosity thermal conductive double-sided tape, easy to install, firmly and persistently adhered.
6. LED light source, energy-saving and environmentally friendly, in compliance with ROHS environmental standards.



## Application:

Widely used in hotels, shoppingmalls, furniture, cabinets, shelf as decoration lighting, direct lighting or indirect lighting



Product parameters:

General parameters

Product Model	GL-HV-288xCOB COB 288 leds/meter
Color	WW, NW, CW,
CCT	3000K/4000K/6000K
CRI	Ra > 80
Beam angle	120°
Cut Distance	50mm

Environmental test parameters

IP grade	IP67
Working environment	-25℃~+45℃
Storage environment	-30℃~+80℃
Max connection Length	50m

Performance parameters

Lumen(±5%)	950lm/m
Efficiency(±5%)	95lm/W
Voltage	AC220V
Electric current	250mA/m
Power	10W/m

Packaging parameters



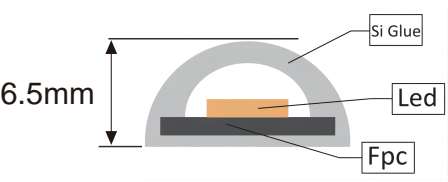
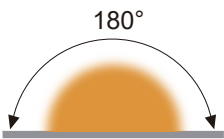
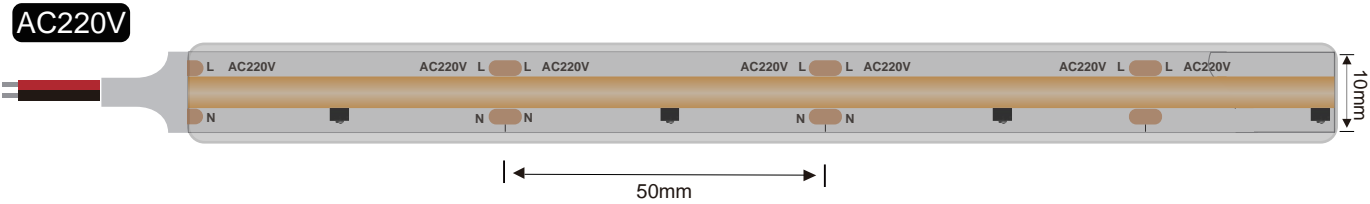



A roll	50m/100m
N.W(Roll)	160g
Qty/Carton	50m-100mroll
Packing size(mm)	L720*W280*H410
G.W	9Kg

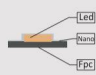
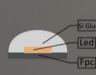
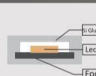

## Processing custom waterproof process:



**Contrast of Process**

IP RATING	STRUCTURE	FEATURE	REMARK
IP20		Non-Waterproof	Indoor Use Only
IP54		Nano Coated	Thin Film Coating Anti Splash Water Tiny Size Changed (Same Looking as IP20)
IP65		Silicone glue Coated Waterproof Suitable for Damp Location	Silicone Glue Coating Dropping Anti Splash Water Tiny Size Changed
IP67A		Silicone Extrusion Waterproof Suitable for Short-time Wet Location	Extruding Process Suitable for outdoor places without standing water
IP67B		Silicone Tube Waterproof Suitable for Damp Location	Silicone Empty Inside Anti Spray Water Tiny Color Shift
IP67C		Silicone Extrusion Waterproof Suitable for Short-time Wet Location	Extruding Process Suitable for outdoor places without standing water
IP67D		U-Tube Instilled Silicone Glue Waterproof Suitable for Short-time Wet Location	Silicone Glue Coating Suitable for outdoor places without standing water
IP68A		Silicone Tube Injected Silicone Glue Waterproof Suitable for Outdoor and Underwater	360° Silicone Filling Use for Outdoor and Underwater
IP68B		Silicone Solid Extrusion Waterproof Suitable for Outdoor and Underwater	360° Silicone Filling Use for Outdoor and Underwater

IP code : Ingress Protection Marking, IEC standard 60529

## Package:

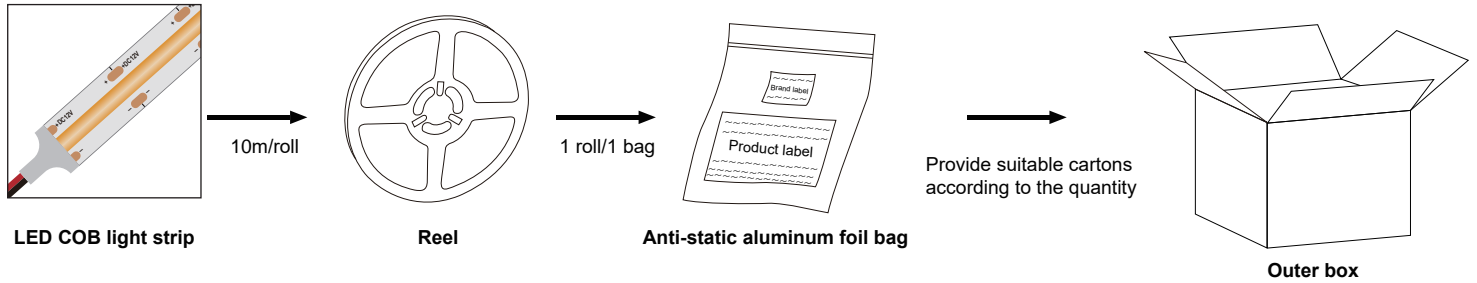

## Installation diagram:

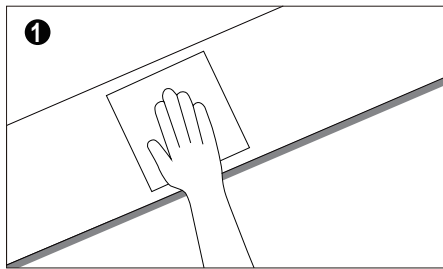

Clean the installation surface

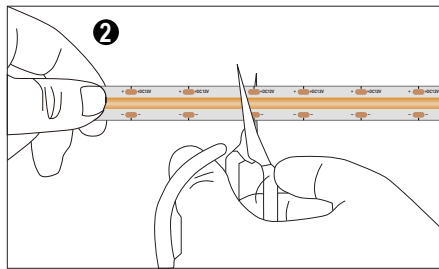

Measure the length you need to install, cut at the nearest scissor mark line.

For the left led strip, weld at the next scissor mark to connect with other connection wire.

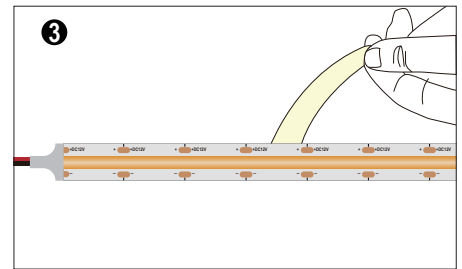

Tear off the double-sided adhesive tape on the back and paste it in a suitable position

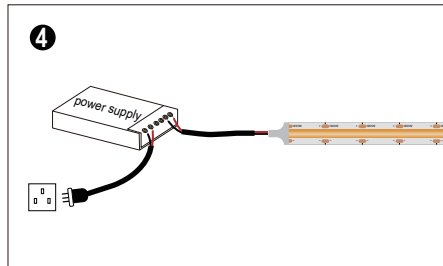

Connect the light strip wire to the driver output port (positive pole to positive pole, negative pole to negative pole)

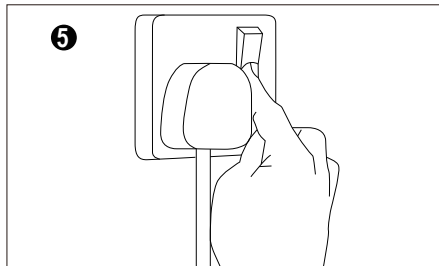

Turn on the power switch after confirming that the line is connected

## Statements :

- 1). For safety, the product wire should be moved and replaced by the manufacturer, agent or other authorized person.
- 2). Please refer to the product manual before installation.
- 3). Above-refered schematic diagrams are from our standard product. Please subject to your actual product data if there is difference.
- 4). In actual use, we suggest 80% consumption of the driver. Keep 20% as power to start the led strip.
- 5). For safety, no touch the AC terminal.
- 6). Any acidic or alkaline substance is forbidden.
- 7). No notice for updated of this product.

Problem	Possible reasons	solution
All fail	<ul style="list-style-type: none"> <li>No power supply</li> </ul>	Give power supply.
	<ul style="list-style-type: none"> <li>Automatic switch-off because of the open circuit and short circuit</li> </ul>	Solve the problem, switch on again.
	<ul style="list-style-type: none"> <li>Wrong connection (positive connect with negative)</li> </ul>	Check and get right connection.
Part fail	<ul style="list-style-type: none"> <li>Part power-supply fail</li> </ul>	Check and make sure the power supply well.
	<ul style="list-style-type: none"> <li>Part circuit error</li> </ul>	
	<ul style="list-style-type: none"> <li>Part wrong connection(positive connect negative)</li> </ul>	Check and get right connection.
Inconsistent brightness or insuffiscent brightness	<ul style="list-style-type: none"> <li>overload of the driver</li> </ul>	Use higher-power driver.
	<ul style="list-style-type: none"> <li>Too big power consumption of the switch, or unbalanced power consumption from different strip series.</li> </ul>	Keep the strip working voltage is more or less 5% than the Rated voltage. 1.shorten the connection cable length, or change to thicker cable. 2.Make sure the strip quantity is less than the allowed connection quantity.Keep the led strip quantity of each series similar).
	<ul style="list-style-type: none"> <li>Too many Led strips connection</li> </ul>	Adjust the led strip quantity, make sure sufficient power supply.
LED flash	<ul style="list-style-type: none"> <li>Poor welding connection of wires</li> </ul>	Check,find and solve it.
	<ul style="list-style-type: none"> <li>switch problem</li> </ul>	Change to right switch.